

ROLLER FOLLOWERS
STAINLESS STEEL
SEPARABLE WITH INNER RING

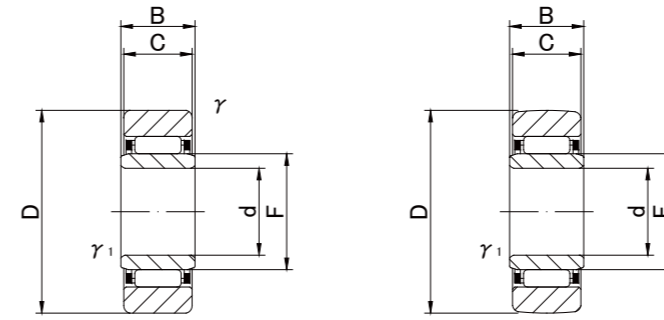

NAST..M



NAST..M

NAST..MR

NAST..M TYPE

Prepacked Grease

Shaft Diameter (mm)	Designation		Dimensions (mm)							Basic dynamic load rating	Basic static load rating	Track load capacity		Limiting speed *	Mass
	Cylindrical outer ring	Crowned outer ring (R500)	d	D	B	C	r's min	r1s min	F			Cr N	Cor N		
6	NAST 6M	NAST 6MR	6 ⁰ _{-0.008}	19	10	9.8	0.3	0.3	10	3 790	4 180	3 530	1 370	20 000	17.8
8	NAST 8M	NAST 8MR	8 ⁰ _{-0.008}	24	10	9.8	0.6	0.3	12	5 220	5 410	4 020	1 860	17 000	28
10	NAST10M	NAST10MR	10 ⁰ _{-0.008}	30	12	11.8	1	0.3	14	8 920	8 890	5 590	2 450	15 000	50
12	NAST12M	NAST12MR	12 ⁰ _{-0.008}	32	12	11.8	1	0.3	16	9 560	10 020	5 980	2 740	13 000	58
15	NAST15M	NAST15MR	15 ⁰ _{-0.008}	35	12	11.8	1	0.3	20	11 310	13 150	6 570	3 140	10 000	62
17	NAST17M	NAST17MR	17 ⁰ _{-0.010}	40	16	15.8	1	0.3	22	16 000	19 220	10 900	3 720	9 500	110
20	NAST20M	NAST20MR	20 ⁰ _{-0.010}	47	16	15.8	1	0.3	25	17 660	22 540	12 700	4 610	8 500	155
25	NAST25M	NAST25MR	25 ⁰ _{-0.010}	52	16	15.8	1	0.3	30	19 040	26 120	14 100	5 290	7 000	180
30	NAST30M	NAST30MR	30 ⁰ _{-0.010}	62	20	19.8	1	0.6	38	27 870	41 760	22 100	6 660	5 500	320
35	NAST35M	NAST35MR	35 ⁰ _{-0.012}	72	20	19.8	1	0.6	42	29 620	46 550	25 700	8 130	5 000	440
40	NAST40M	NAST40MR	40 ⁰ _{-0.012}	80	20	19.8	1.5	1	50	32 840	56 210	26 900	9 310	4 000	530
45	NAST45M	NAST45MR	45 ⁰ _{-0.012}	85	20	19.8	1.5	1	55	34 130	61 080	28 500	10 100	4 000	580
50	NAST50M	NAST50MR	50 ⁰ _{-0.012}	90	20	19.8	1.5	1	60	35 600	66 050	30 200	11 000	3 500	635

* Suitable for grease lubrication. In case of oil lubrication, up to 130% of this value shall be permissible.

OUTER RINGS TOLERANCE (Outside diameter) (µm)

TYPE	Cylindrical outer ring	Crowned outer ring
NAST6M,NAST8M,NAST10M	0/-9	0/-50
NAST12M,NAST15M,NAST17M,NAST20M	0/-11	0/-50
NAST25M,NAST30M,NAST35M,NAST40M	0/-13	0/-50
NAST45M,NAST50M	0/-15	0/-50